

SITE PLAN  
-OF-

LOT 62, WHISPERING PINES SECOND ADDITION, BEING PART OF  
THE NORTHWEST 1/4 OF THE SOUTHEAST 1/4 OF SECTION 13,  
TOWN 2 NORTH, RANGE 15 EAST, IN THE CITY OF DELAVAN,  
COUNTY OF WALWORTH, STATE OF WISCONSIN.

SURVEY FOR: SOUTHEASTERN HOUSING CORP.

PROPOSED ADDRESS: \_\_\_\_\_ PINE STREET

NOTE: LOT TO BE SURVEYED AND HOUSE TO BE STAKED UPON  
NOTIFICATION BY THE ABOVE NAMED CLIENT.

PINE  
66' WIDE  
STREET

SCALE: 1" = 30'



B.W. SURVEYING

412 N. PINE STREET  
BURLINGTON, WI 53105  
(262)-767-0225

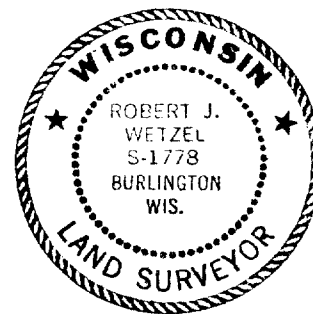
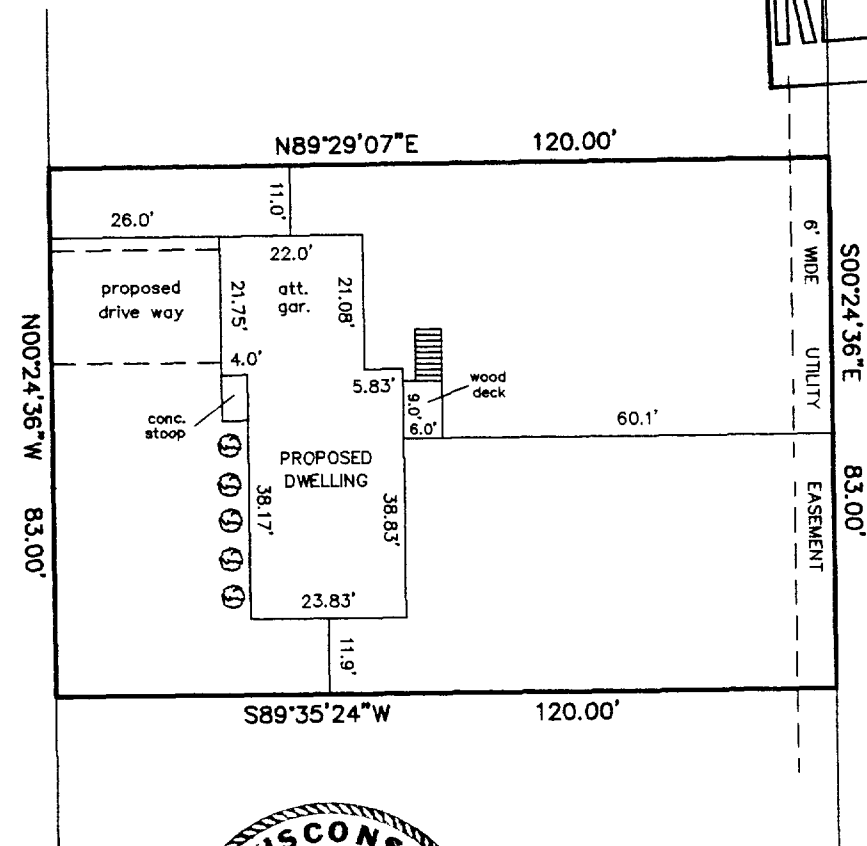

THIS IS NOT AN ORIGINAL PRINT  
UNLESS THIS SEAL IS RED.

*Robert J. Wetzel*  
ROBERT J. WETZEL S-1778

REVISED: APRIL 27, 2000  
OCTOBER 26, 1999  
DATE

4230  
JOB NUMBER

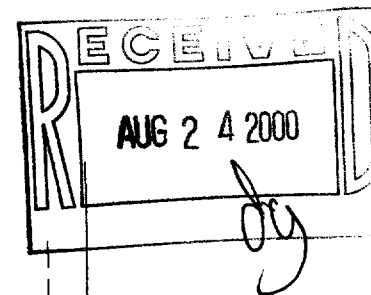

XWP2-9

002-1860